

COMHAIRLE CONTAE AN CHLÁIR
CLARE COUNTY COUNCIL



Bonneagar Iompair Éireann
Transport Infrastructure Ireland



ROUGHAN & O'DONOVAN

ROUGHAN & O'DONOVAN
CONSULTING ENGINEERS

Offices:
Dublin - Sandford & Santry
Leeds - Otey
Ireland t +353 (0) 1 294 0800
UK t +44 (0) 113 360 1720

Project Title

WEST CLARE RAILWAY GREENWAY
SECTION 1: KILRUSH TO KILKEE

ENVIRONMENTAL IMPACT ASSESSMENT REPORT

Drawing Title:

LAND HOLDINGS
SHEET 1 OF 8

Drawn: LA	File:	Status: E.I.A.R.
Designed: LL	Job No: 21.121	Drawing No: Fig 17.1
Checked: LL	Scale: 1:2,500	Rev: P0
Approved: EOC	Date: April 2026	

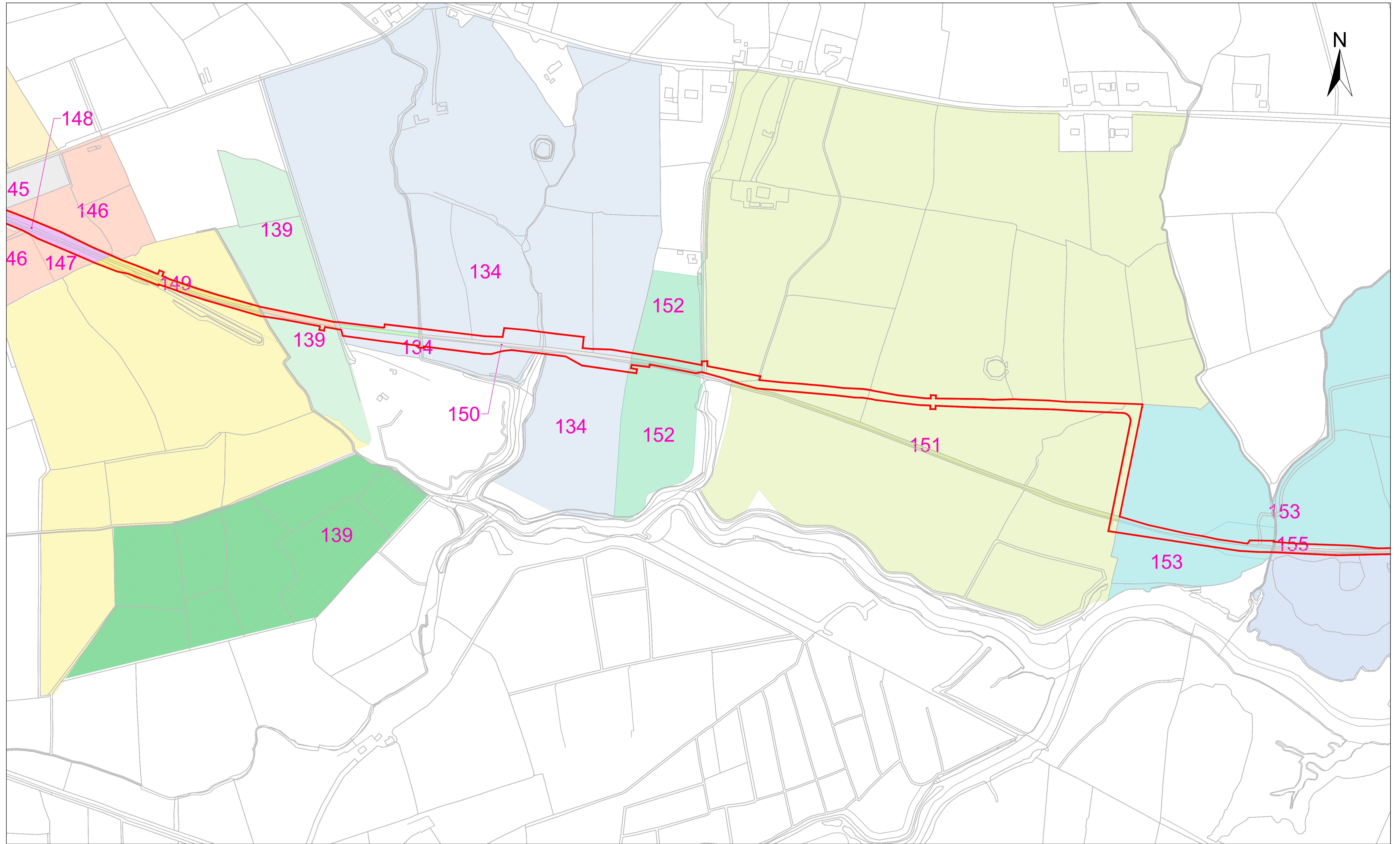

COMHAIRLE CONTAE AN CHLÁIR
CLARE COUNTY COUNCIL



Bonneagar Iompair Éireann
Transport Infrastructure Ireland



ROUGHAN & O'DONOVAN

ROUGHAN & O'DONOVAN
CONSULTING ENGINEERS

Offices:
Dublin - Sandford & Santry
Leeds - Otey
Ireland t +353 (0) 1 294 0800
UK t +44 (0) 113 360 1720

Project Title

WEST CLARE RAILWAY GREENWAY
SECTION 1: KILRUSH TO KILKEE

ENVIRONMENTAL IMPACT ASSESSMENT REPORT

Drawing Title:

LAND HOLDINGS
SHEET 2 OF 8

Drawn: LA	File:	Status: E.I.A.R.
Designed: LL	Job No: 21.121	Drawing No: Fig 17.2
Checked: LL	Scale: 1:2,500	Rev: P0
Approved: EOC	Date: April 2026	

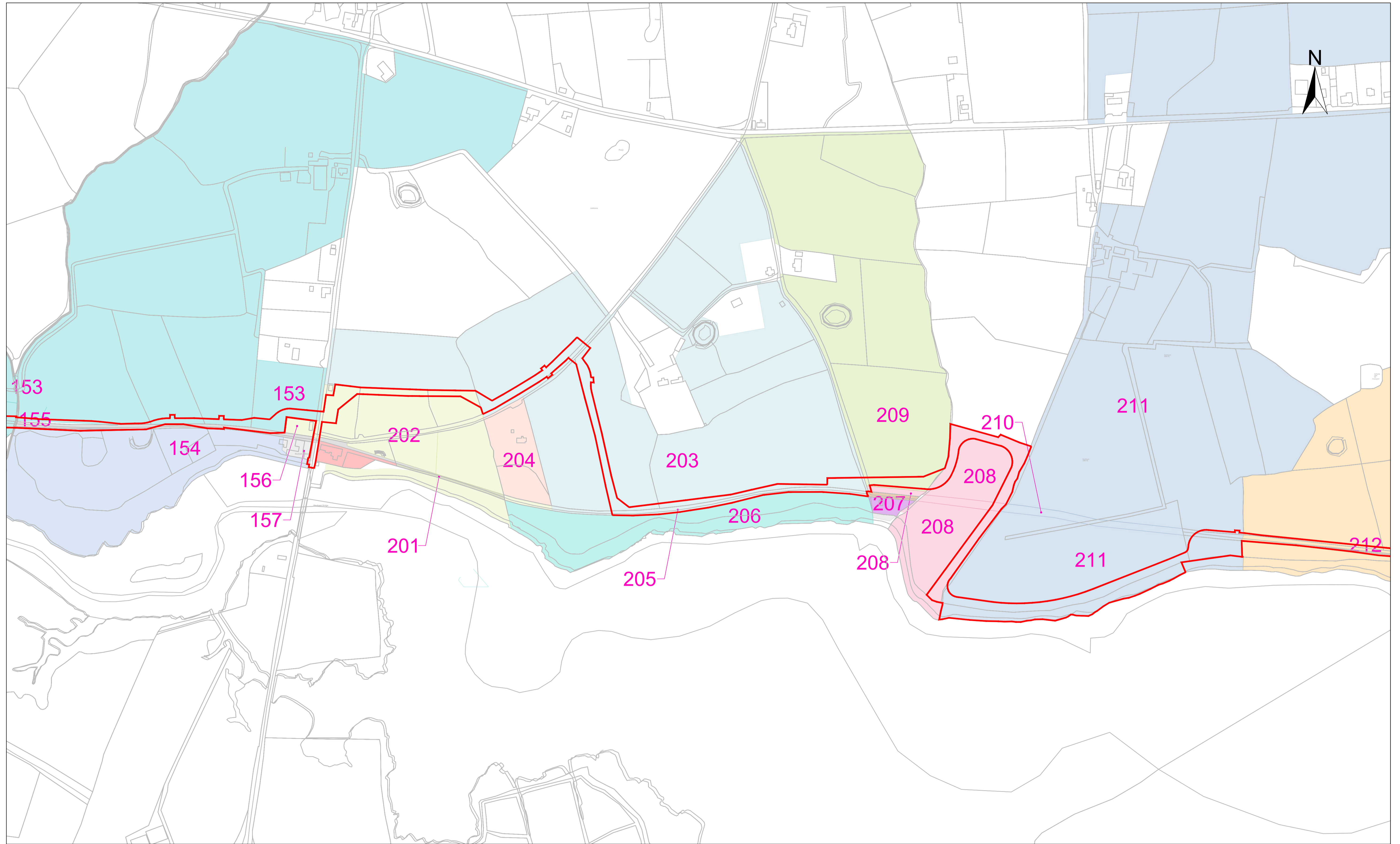

COMHAIRLE CONTAE AN CHLÁIR
CLARE COUNTY COUNCIL



Bonneagar Iompair Éireann
Transport Infrastructure Ireland



ROUGHAN & O'DONOVAN

ROUGHAN & O'DONOVAN
CONSULTING ENGINEERS

Offices:
Dublin - Sandford & Santry
Leeds - Otey
Ireland t +353 (0) 1 294 0800
UK t +44 (0) 113 360 1720

Project Title

WEST CLARE RAILWAY GREENWAY
SECTION 1: KILRUSH TO KILKEE

ENVIRONMENTAL IMPACT ASSESSMENT REPORT

Drawing Title:

LAND HOLDINGS
SHEET 3 OF 8

Drawn: LA	File:	Status: E.I.A.R.
Designed: LL	Job No: 21.121	
Checked: LL	Scale: 1:2,500	Drawing No: Fig 17.3
Approved: EOC	Date: April 2026	Rev: P0

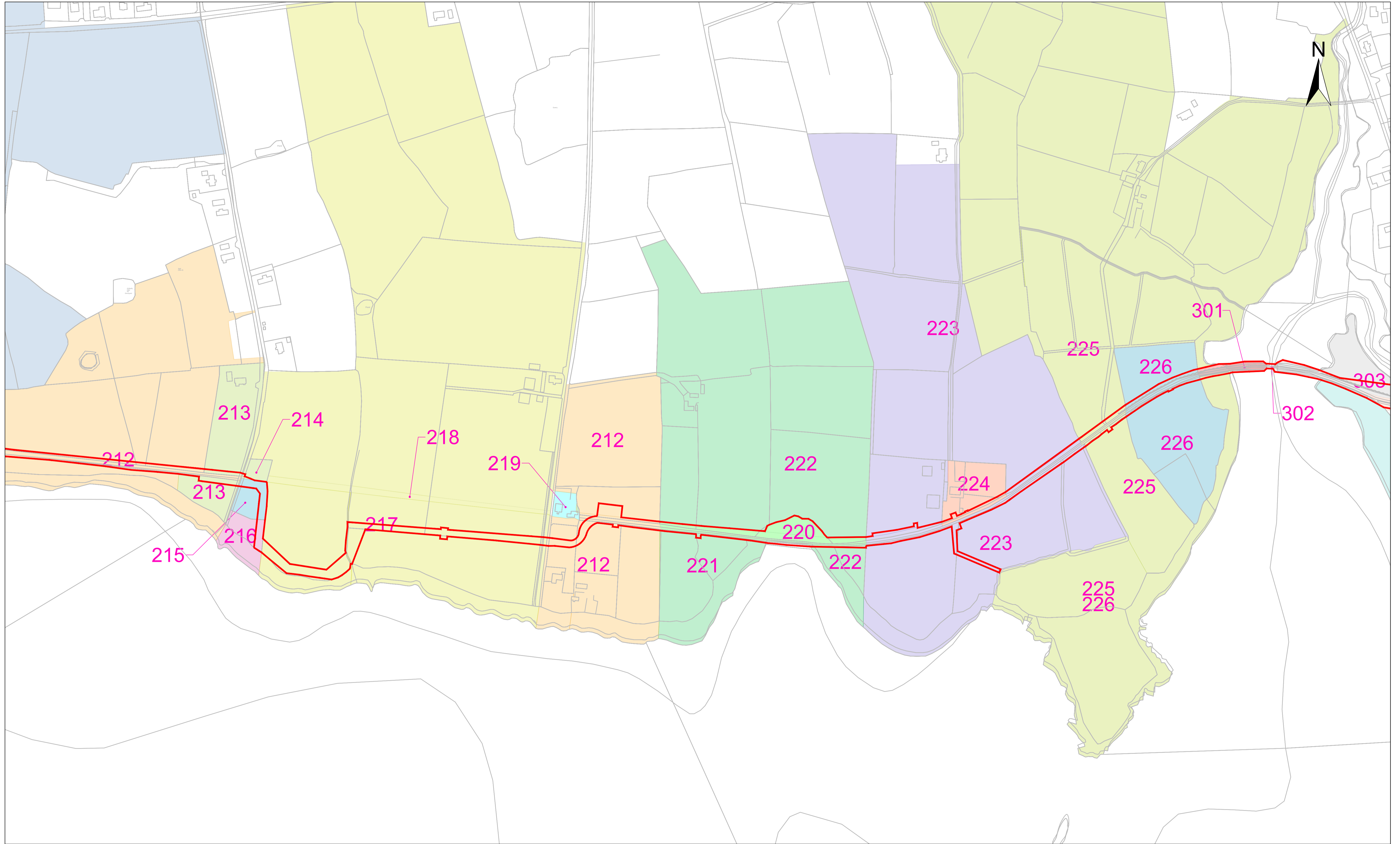

ROUGHAN & O'DONOVAN
CONSULTING ENGINEERS

Offices:
Dublin - Sandford & Santry
Leeds - Otley
Ireland t +353 (0) 1 294 0800
UK t +44 (0) 113 360 1720

Project Title

WEST CLARE RAILWAY GREENWAY
SECTION 1: KILRUSH TO KILKEE

ENVIRONMENTAL IMPACT ASSESSMENT REPORT

Drawing Title:

LAND HOLDINGS
SHEET 4 OF 8

Drawn: LA	File:	Status: E.I.A.R.
Designed: LL	Job No: 21.121	
Checked: LL	Scale: 1:2,500	Drawing No: Fig 17.4
Approved: EOC	Date: April 2026	Rev: P0

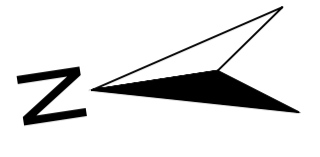
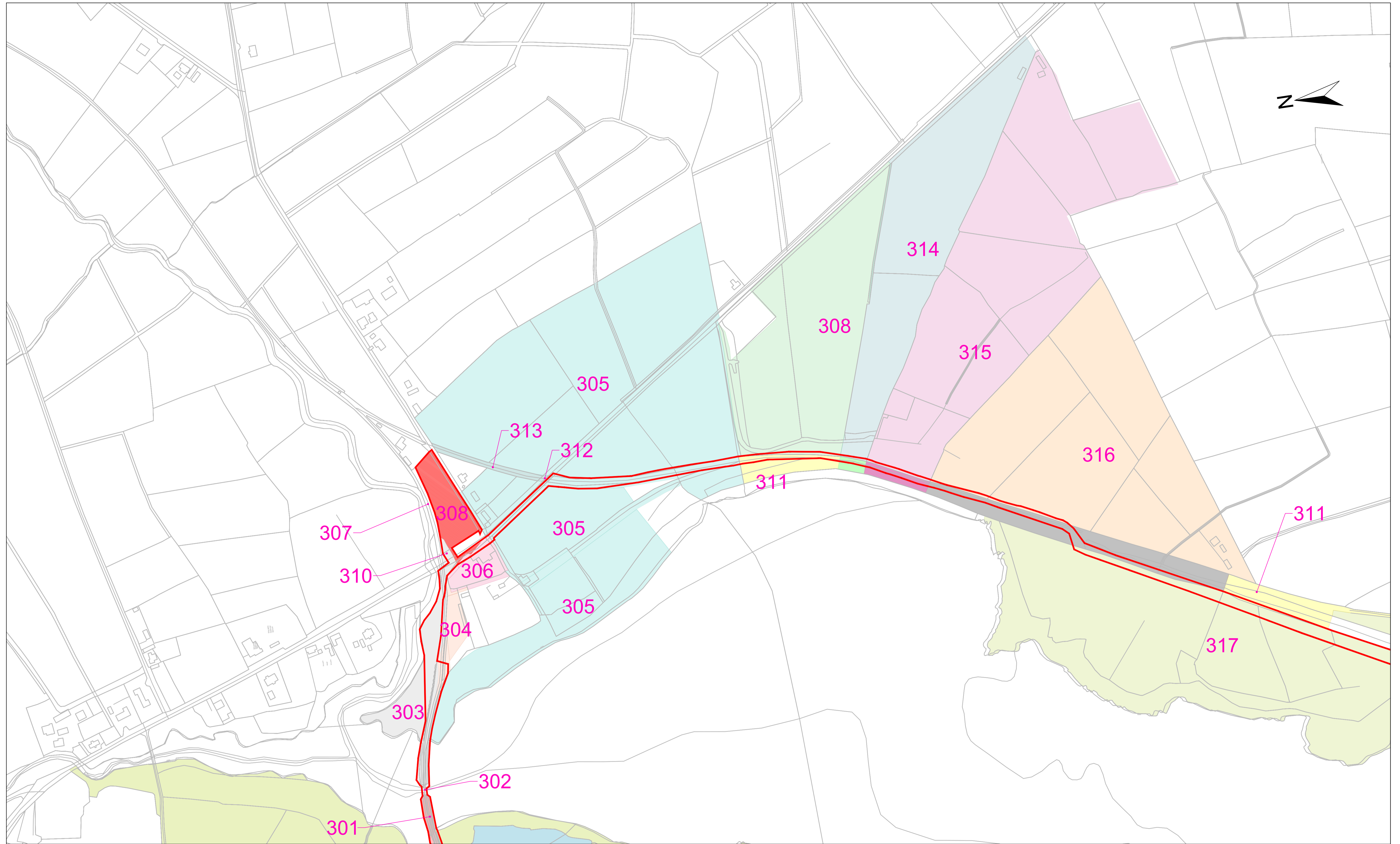

ROUGHAN & O'DONOVAN
CONSULTING ENGINEERS

Offices:
Dublin - Sandford & Santry
Leeds - Otey
Ireland t +353 (0) 1 294 0800
UK t +44 (0) 113 360 1720

Project Title	WEST CLARE RAILWAY GREENWAY SECTION 1: KILRUSH TO KILKEE	
	ENVIRONMENTAL IMPACT ASSESSMENT REPORT	

Drawing Title:			LAND HOLDINGS SHEET 5 OF 8		
Drawn:	LA	File:		Status:	E.I.A.R.
Designed:	LL	Job No:	21.121		
Checked:	LL	Scale:	1:2,500	Drawing No:	Fig 17.5
Approved:	EOC	Date:	April 2026	Rev:	P0

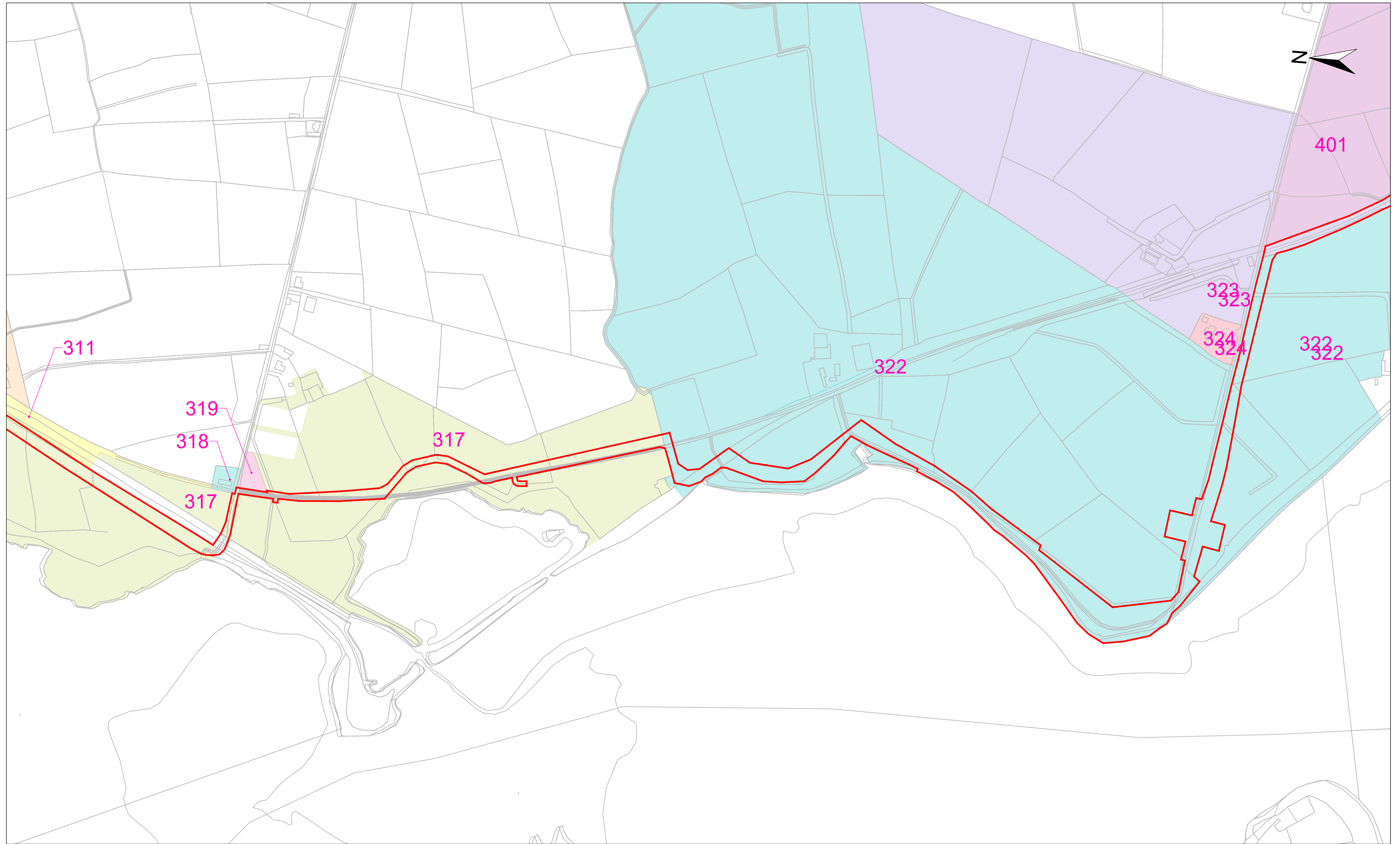

COMHAIRLE CONTAE AN CHLÁIR
CLARE COUNTY COUNCIL



Bonneagar Iompair Éireann
Transport Infrastructure Ireland



ROUGHAN & O'DONOVAN

ROUGHAN & O'DONOVAN
CONSULTING ENGINEERS

Offices:
Dublin - Sandford & Santry
Leeds - Otley
Ireland t +353 (0) 1 294 0800
UK t +44 (0) 113 360 1720

Project Title

WEST CLARE RAILWAY GREENWAY
SECTION 1: KILRUSH TO KILKEE

ENVIRONMENTAL IMPACT ASSESSMENT REPORT

Drawing Title:

LAND HOLDINGS
SHEET 6 OF 8

Drawn: LA	File:	Status: E.I.A.R.
Designed: LL	Job No: 21.121	
Checked: LL	Scale: 1:2,500	Drawing No: Fig 17.6
Approved: EOC	Date: April 2026	Rev: P0

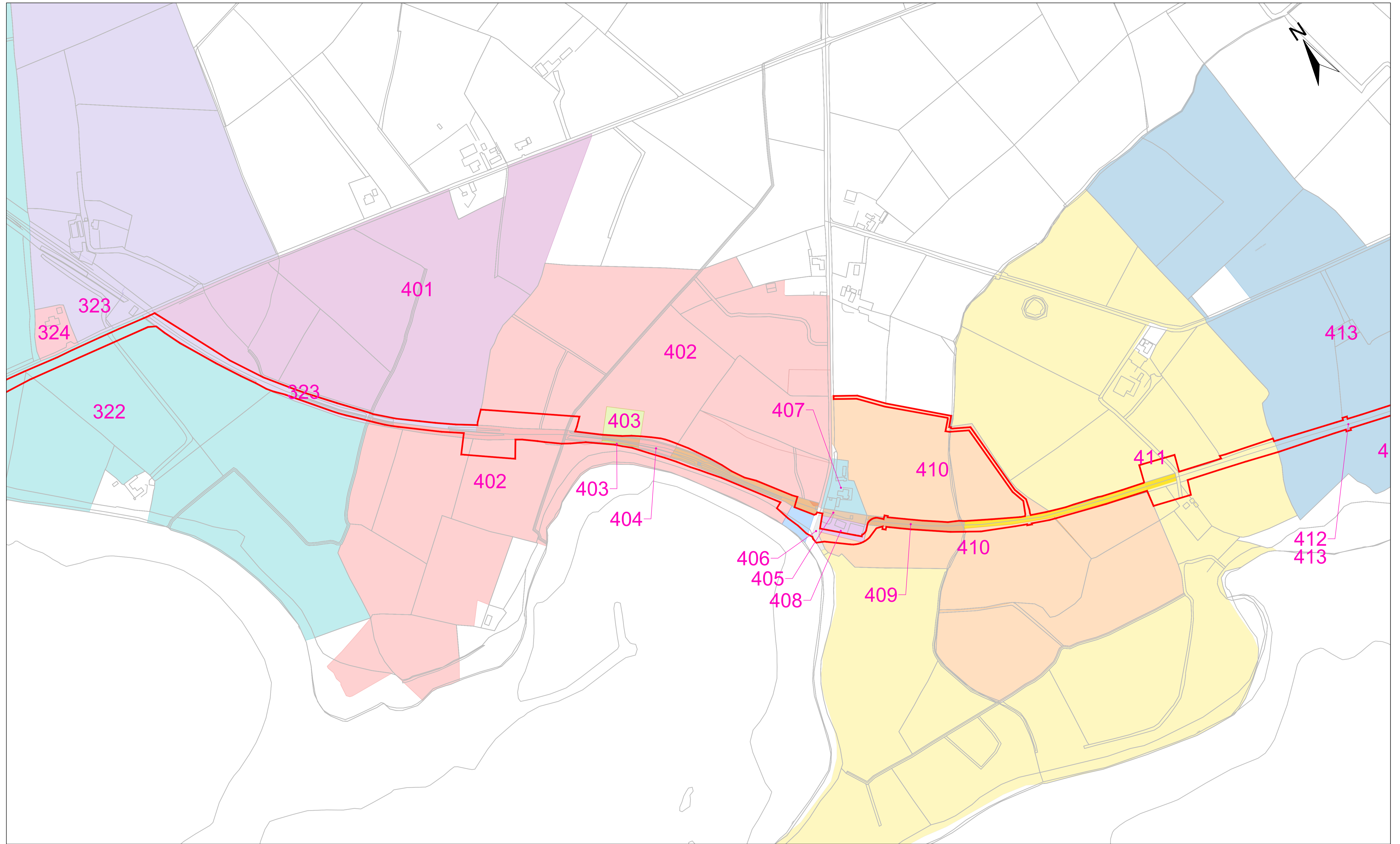

COMHAIRLE CONTAE AN CHLÁIR
CLARE COUNTY COUNCIL



ROUGHAN & O'DONOVAN
CONSULTING ENGINEERS

Offices:
Dublin - Sandford & Santry
Leeds - Otey
Ireland t +353 (0) 1 294 0800
UK t +44 (0) 113 360 1720

Project Title

WEST CLARE RAILWAY GREENWAY
SECTION 1: KILRUSH TO KILKEE

ENVIRONMENTAL IMPACT ASSESSMENT REPORT

Drawing Title:

LAND HOLDINGS
SHEET 7 OF 8

Drawn: LA	File:	Status: E.I.A.R.
Designed: LL	Job No: 21.121	
Checked: LL	Scale: 1:2,500	Drawing No: Fig 17.7
Approved: EOC	Date: April 2026	Rev: P0

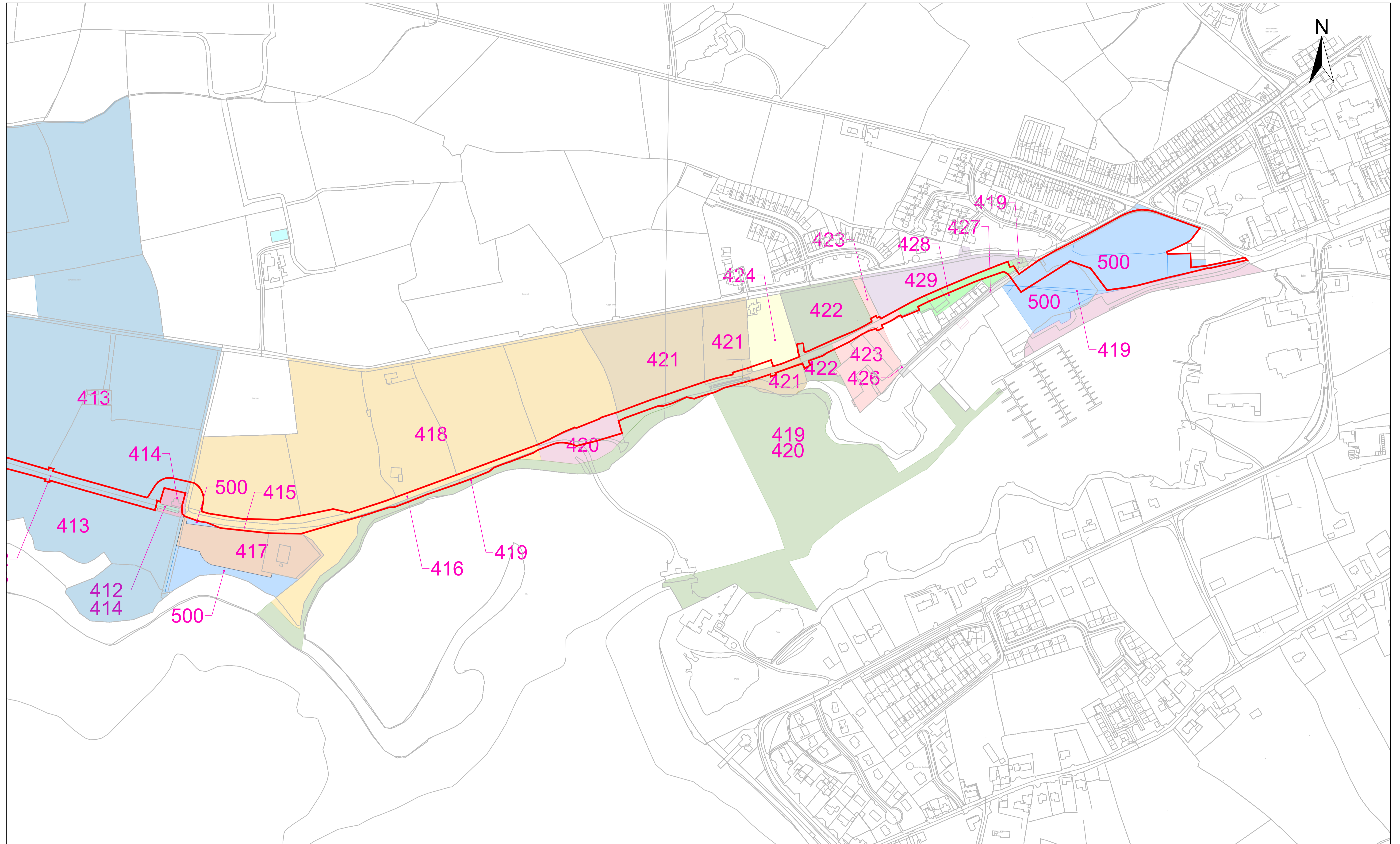

COMHAIRLE CONTAE AN CHLÁIR
CLARE COUNTY COUNCIL



ROUGHAN & O'DONOVAN
CONSULTING ENGINEERS

Offices:
Dublin - Sandford & Santry
Leeds - Otey
Ireland t +353 (0) 1 294 0800
UK t +44 (0) 113 360 1720

Project Title

WEST CLARE RAILWAY GREENWAY
SECTION 1: KILRUSH TO KILKEE

ENVIRONMENTAL IMPACT ASSESSMENT REPORT

Drawing Title:

LAND HOLDINGS
SHEET 8 OF 8

Drawn: LA	File:	Status: E.I.A.R.
Designed: LL	Job No: 21.121	
Checked: LL	Scale: 1:2,500	Drawing No: Fig 17.8
Approved: EOC	Date: April 2026	Rev: P0